

# CONTENDER

## CT-8000 HiL

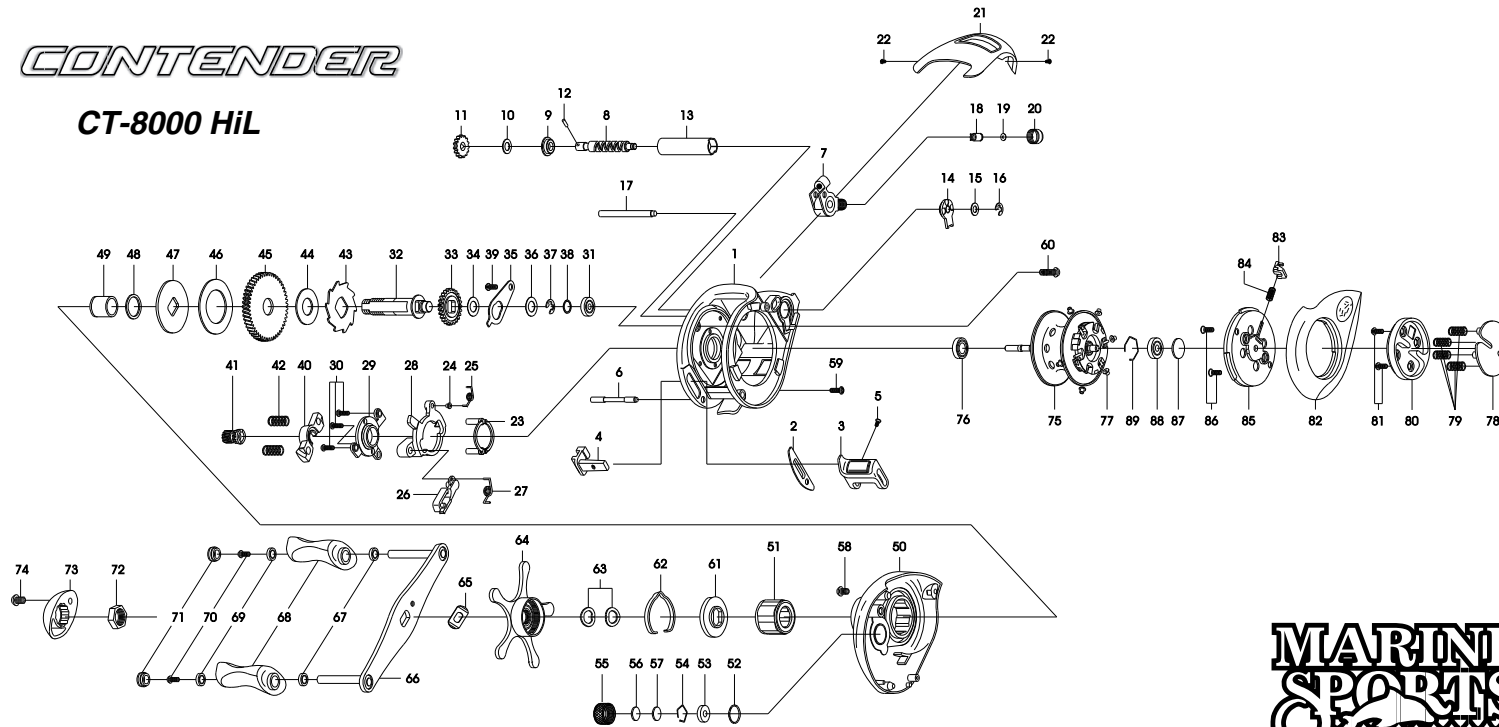

THE ORDER OF THE PART NUMBER IS BASED ON THAT OF THE REEL ASSEMBLY

NO	PART NAME	NO	PART NAME	NO	PART NAME	NO	PART NAME	NO	PART NAME	NO	PART NAME
1	FRAME	16	E-RING	31	BALL BEARING	46	DRAG WASHER (B)	61	CLICK PLATE	76	BALL BEARING
2	CLUTCH BAR PLATE	17	PILLAR	32	CRANK SHAFT	47	DRAG WASHER (D)	62	CLICK LEAF SPRING	77	BRAKE COLLAR(WHITE)(+6)
3	CLUTCH BAR ASSEMBLY	18	LINE GUIDE PAWL	33	IDLER(L)	48	SLEEVE WASHER(OPTIONAL)	63	DRAG SPRING WASHER(+2)	78	LEVER PLATE
4	CLUTCH LINK	19	SPACER(OPTIONAL)	34	IDLER(L) WASHER(A)(OPTIONAL)	49	SLEEVE	64	STAR DRAG ASSEMBLY	79	LEVER PLATE SPRING(+4)
5	CLUTCH BAR SCREW	20	PAWL CAP	35	BEARING PLATE	50	RIGHT SIDE COVER	65	LEAF SPRING	80	LOCK LEVER
6	CLUTCH BAR SUPPORT	21	FRONT COVER	36	IDLER(L) WASHER (B)	51	ONE WAY CLUTCH	66	HANDLE ASSEMBLY	81	LOCK LEVER SCREW(+2)
7	LINE GUIDE ASSEMBLY	22	FRONT COVER SCREW(+2)	37	E-RING	52	O-RING	67	BALL BEARING(+2)	82	LEFT SIDE COVER ASSEMBLY
8	WORM SHAFT	23	YOKE HOLDER	38	CRANK SHAFT SPACER(OPTIONAL)	53	BUSHING	68	HANDLE KNOB(+2)	83	LOCK PIN
9	WORM SHAFT BUSHING (A)	24	CLUTCH SPRING BUSHING	39	BEARING PLATE SCREW	54	BEARING RETAINER	69	BALL BEARING(+2)	84	LOCK PIN SPRING
10	IDLER(S) WASHER(OPTIONAL)	25	CLUTCH SPRING	40	PINION YOKE	55	CAST CONTROL CAP	70	SCREW(+2)	85	SPOOL COVER ASSEMBLY
11	IDLER(S)	26	RETURN PAWL	41	PINION GEAR	56	TENSION WASHER	71	HANDLE KNOB CAP(+2)	86	SPOOL COVER SCREW(+2)
12	WORM SHAFT PIN	27	RETURN PAWL SPRING	42	PINION YOKE SPRING(+2)	57	SPOOL SPACER (B)	72	HANDLE NUT	87	SPOOL SPACER(A)
13	LINE GUIDE PIPE	28	CLUTCH CAM	43	RATCHET	58	RIGHT SIDE COVER SCREW (A)	73	HANDLE NUT CAP	88	BALL BEARING
14	WORM SHAFT BUSHING (B)	29	CAM PLATE	44	RATCHET WASHER	59	RIGHT SIDE COVER SCREW (B)	74	HANDLE NUT CAP SCREW	89	BEARING RETAINER
15	WORM SHAFT WASHER(OPTIONAL)	30	CAM PLATE SCREW(+3)	45	DRIVE GEAR	60	RIGHT SIDE COVER SCREW (C)	75	SPOOL ASSEMBLY		